



Minneapolis Police Department 2007 Neighborhood Policing Plan *Sheridan Neighborhood*

Introduction:

The Sheridan Neighborhood is in the Minneapolis Police Department's Second Precinct.

Neighborhood Map:

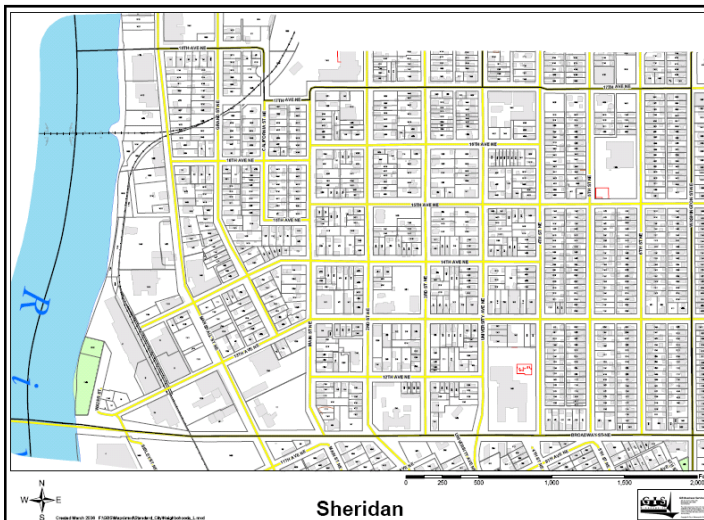

Precinct Contacts:

Second Precinct		673-5702
Crime Prevention Specialist	Richard Maas	673-2797
Sector Commander	Lt. Bob Kroll	673-3678
Precinct Commander	Insp. Bob Skomra	673-5702

Overview:

The Sheridan neighborhood is located in northeast Minneapolis. It extends from Washington Street NE on the east to the Mississippi River on the west, and from Broadway Street NE on the south to 18th and 17th avenues NE on the north. It is named for Civil War General Philip Sheridan. The neighborhood elementary and junior high schools and the local park are all named after General Sheridan too. A large portion of the neighborhood was built for industrial use of the Mississippi River, but there is potential for new housing in these industrial areas. The Sheridan neighborhood also has a sizable amount of small apartment buildings.

Crime Statistics:

Sheridan remains a safe neighborhood in northeast Minneapolis, while a comparison of the 2006 *Part 1 Crime statistics with 2005 for the neighborhood shows that the number of Robberies increased from 27 to 78, Aggravated Assault increased from 32 to 62, and Theft/Larceny increased from 132 to 223. All other Part 1 Crimes stayed relatively the same.

*Part 1 Crimes include: Homicide, Rape, Robbery, Aggravated Assault, Burglary, Larceny/Theft, Auto Theft and Arson

Neighborhood Concerns:

- Personal Safety at the local bars in the neighborhood.
- Vandalism in the neighborhood, damage to vehicles parked on the street or in driveways
- Unsupervised Youth. Curfew and truancy issues.
- Increase of previously mentioned Part 1 Crimes in the neighborhood over the last calendar year.

2007 Policing Strategy:

The Minneapolis Police Department has two citywide goals: reduce crime and improve the relationship with the community it serves. In the Sheridan neighborhood, we will focus on the following crime reduction strategies:

- Reducing Robberies & Aggravated Assaults. Hosting Personal Safety Workshops (coordinated with the Crime Prevention Specialist) to provide residents the opportunity to be safe when out in the neighborhood
- Encouraging residents to report problems in the community by calling 911, 311 and/or their Crime Prevention Specialist to discuss their concerns.
- Utilizing the information received from the community by their reporting of problems via 911, 311 and/or the Crime Prevention Specialist and the weekly Codefor meeting to best focus precinct resources.

The MPD will also engage in two projects to increase the relationship with the community:

- Increase communication with people in the neighborhood via the city WorkSite program, which is designed to facilitate stronger communication and information sharing in the community through web-based technology.
- Provide Block Leader Training (contact Crime Prevention Specialist) periodically throughout the year so residents are looking out for each other and that concerns are being directed to the proper City agency to handle.

Neighborhood Engagement:

While the Minneapolis Police Department has committed to a number of steps to improve policing service in Sheridan, policing is a team sport and residents need to be part of that team. The collaboration of MPD and Residents, through SHARC, have committed to the following:

- Create Old Liquor District Consortium with the surrounding neighborhoods to address some of the concerns concerning personal safety around the bars. (Contact Neighborhood Organization for more information)
- Participating fully in the city WorkSite communications tool.

For more information on the Sheridan Neighborhood contact

'sno@sheridanneighborhood.org'

2007 Performance Measures:

The following criteria will be used to measure success in the Sheridan Neighborhood:

- 5% decrease the number of Part 1 Crimes in the neighborhood – especially Robberies and Aggravated Assaults.
- Increase in number of people that have signed on to City WorkSite or for the Sector e-mail alert system.