



Minneapolis Police Department 2008 Neighborhood Policing Plan *Waite Park Neighborhood*

Introduction:

The Waite Park Neighborhood is in the Minneapolis Police Department's Second Precinct.

Neighborhood Map:

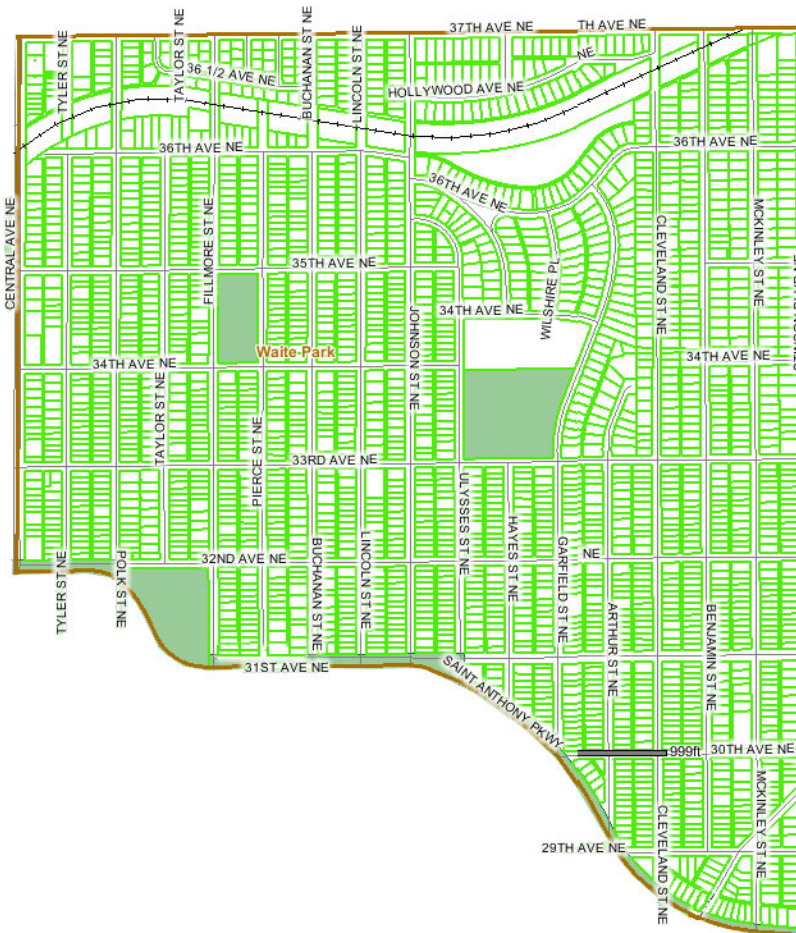

Precinct Contacts:

Second Precinct	612-673-5702
Crime Prevention Specialist (currently open; leave messages)	612-673-2797
Sector Commander	Lt. Bob Kroll 612-673-5702
Precinct Commander	Insp. Bob Skomra 612-673-5702

Overview:

Waite Park neighborhood, in the city's northeast corner, is bound on the north by 37th Avenue Northeast, on the east by Stinson Boulevard, on the south by Saint Anthony Parkway and on the west by Central Avenue Northeast. The neighborhood is named for Edward Foote Waite, judge of the District Court of Hennepin County from 1911 to 1941. In 1887, the city incorporated most of the land in the neighborhood. By that time the railroad had built a large repair facility, the Shoreham Yards. The facility is still in use, but the land it's on is expected to be redeveloped. Waite Park is a mainly residential neighborhood.

Crime Statistics:

Waite Park remains one of the safer neighborhoods in northeast Minneapolis, a comparison of the 2007 *Part 1 Crime statistics with 2006 for the neighborhood shows that the number of Robberies increased from 6 to 10, Residential Burglary from 49 to 54 and Larcenies/Thefts increased from 47 to 77. All other Part 1 Crimes went down or stayed relatively the same. (*Part 1 Crimes include: Homicide, Rape, Robbery, Aggravated Assault, Burglary, Larceny/Theft, Auto Theft & Arson)

Neighborhood Concerns:

- The increase in the number of Robbery of Persons that have occurred in the neighborhood over the past calendar year.
- The increase in the number of Residential Burglaries and Larcenies/Thefts that have occurred in the neighborhood over the past calendar year.
- Unsupervised youth in the community.

2008 Policing Strategy:

The Minneapolis Police Department has two citywide goals: reduce crime and improve the relationship with the community it serves. In the Waite Park neighborhood, we will be focus on the following crime reduction strategies:

- Reducing Robberies. Hosting Personal Safety Workshops to provide residents the opportunity to be safe when out in the neighborhood
- Encouraging residents to report problems in the community by calling 911, 311 and/or their Crime Prevention Specialist to discuss their concerns.
- Reducing Burglaries. Offering Premise Security Surveys (contact your Sector Crime Prevention Specialist) to residents in order to make their property less inviting to criminals and promoting the utilization of the various City electronic technologies for information dissemination.
- Utilizing the information received from the community by their reporting of problems via 911, 311 and/or the Sector Crime Prevention Specialist to assist in deploying the officers out in the precinct each week as discussed at the weekly CODEFOR meeting.
- Utilize the new Juvenile Supervision Center by taking youth picked up for Curfew and Truancy status offenses to the Center for assessment and referral.

We will also engage in two projects to increase the relationship with the community:

- We will increase communication with people in the neighborhood via the city WorkSite program, which is designed to facilitate stronger communication and information sharing in the community through web-based technology.
- Provide Block Leader Training (contact your Crime Prevention Specialist) periodically throughout the year so residents are looking out for each other and that concerns are being directed to the proper City agency to handle.

Neighborhood Engagement:

While the Minneapolis Police Department has committed to a number of steps to improve policing service in Waite Park, policing is a team sport and residents are a key part of that team. The collaboration of MPD with the residents of the neighborhood have committed to the following:

- New Neighborhood Block Club. Work towards adding at least one new block club in the Waite Park Neighborhood during the year. To be promoted by the Neighborhood Association and trained by the Crime Prevention Specialist.
- Participating fully in the city WorkSite communications tool.
- Assist the Minneapolis Police Department in promoting Block Leader Training and Personal Safety Workshops throughout the Waite Park Neighborhood.
- Have Waite Park Neighborhood represented at the monthly 2nd Precinct Advisory Council (2 PAC) meeting held on the 2nd Monday of each month at 6:00 PM at 1900 Central Ave NE.

For more information on the Waite Park Neighborhood contact

'waiteparkcc@gmail.com'

2008 Performance Measures:

We will use the following criteria to measure success in the Waite Park Neighborhood:

- 5% decrease the number of Part 1 Crimes in the neighborhood – especially Robberies, Burglaries and Thefts.
- Add at least one new block club in the neighborhood during the year.

WAITE PARK – 2007 NEIGHBORHOOD PLAN RESULTS

2007 Policing Strategy:

The Minneapolis Police Department has two citywide goals: reduce crime and improve the relationship with the community it serves. In the Waite Park neighborhood, we will be focus on the following crime reduction strategies:

- Reducing Robberies. Hosting Personal Safety Workshops to provide residents the opportunity to be safe when out in the neighborhood. **Ongoing due to increase in Robberies**

- Encouraging residents to report problems in the community by calling 911, 311 and/or their Crime Prevention Specialist to discuss their concerns. **Ongoing**
- Utilizing the information received from the community by their reporting of problems via 911, 311 and/or the Sector Crime Prevention Specialist to assist in deploying the officers out in the precinct each week as discussed at the weekly CODEFOR meeting. **Ongoing**

We will also engage in two projects to increase the relationship with the community:

- We will increase communication with people in the neighborhood via the city WorkSite program, which is designed to facilitate stronger communication and information sharing in the community through web-based technology. **Ongoing**
- Provide Block Leader Training (contact your Crime Prevention Specialist) periodically throughout the year so residents are looking out for each other and that concerns are being directed to the proper City agency to handle. **Completed**

Neighborhood Engagement:

While the Minneapolis Police Department has committed to a number of steps to improve policing service in Waite Park, policing is a team sport and residents need to be part of that team. The collaboration of MPD with the residents of the neighborhood have committed to the following:

- Participating fully in the city WorkSite communications tool. **Ongoing**
- Assist the Minneapolis Police Department in promoting Block Leader Training and Personal Safety Workshops throughout the Waite Park Neighborhood. **Completed**
- Have Waite Park Neighborhood represented at the monthly 2nd Precinct Advisory Council (2 PAC) meeting held on the 2nd Monday of each month at 6:00 PM at 1900 Central Ave NE. **Ongoing**

2007 Performance Measures:

We will use the following criteria to measure our success in policing the Waite Park Neighborhood:

- 5% decrease the number of Part 1 Crimes in the neighborhood – especially Robberies & Thefts. **Goal partially met – most crimes went down with the exception of Robberies & Thefts**
- Increase in number of people that have signed on to City WorkSite or for the Sector e-mail alert system. **Transferring to new e-mail system – measures not yet available**

--- end of 2008 Plan; 2007 Results for Waite Park Neighborhood