



Minneapolis Police Department 2009 Neighborhood Policing Plan *Waite Park Neighborhood*

Introduction:

The Waite Park Neighborhood is in the Minneapolis Police Department's Second Precinct.

Neighborhood Map:

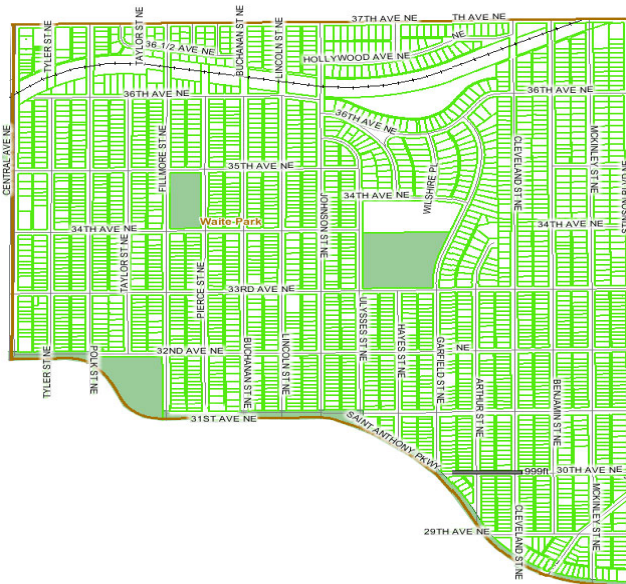

Precinct Contacts:

Second Precinct		612-673-5702
Crime Prevention Specialist	Carol Oosterhuis	612-673-2874
Sector Commander	Lt. Bob Kroll	612-673-5702
Precinct Commander	Insp. Bob Skomra	612-673-5702

Overview:

Waite Park neighborhood, in the city's northeast corner, is bound on the north by 37th Avenue Northeast, on the east by Stinson Boulevard, on the south by Saint Anthony Parkway and on the west by Central Avenue Northeast. The neighborhood is named for Edward Foote Waite, judge of the District Court of Hennepin County from 1911 to 1941. In 1887, the city incorporated most of the land in the neighborhood. By that time the railroad had built a large repair facility, the Shoreham Yards. The facility is still in use, but the land it's on is expected to be redeveloped. Waite Park is a mainly residential neighborhood.

Crime Statistics:

Waite Park Neighborhood remains a safe neighborhood in northeast Minneapolis, a comparison of the 2008 Part 1 Crime statistics with 2007 Part 1 crimes for the neighborhood shows that the number of Burglaries decreased from 52 to 41 and Aggravated Assaults from 4 to 3. There was a 29% decrease in part 1 crimes in the neighborhood during 2008 when compared with 2007. (*Part 1 Crimes include: Homicide, Rape, Robbery, Aggravated Assault, Burglary, Larceny/Theft, Auto Theft and Arson).

<http://www.ci.minneapolis.mn.us/police/crime-statistics/>

Neighborhood Concerns:

- The number of Part 1 Crimes that have occurred in the neighborhood over the past year.
- Problem Properties in the neighborhood.
- Business development along Central Avenue NE
- Unsupervised youth in the community

Focus for 2009:

- Burglary of dwelling – Inspector Skomra set this as a priority to maintain our reductions in 2008
- Crimes of Violence – Inspector Skomra set this as a priority to maintain our reductions in 2008

2009 Policing Strategy:

The Minneapolis Police Department has two citywide goals: reduce crime and improve the relationship with the community it serves. In the Waite Park Neighborhood, we will be focusing on the following crime prevention strategies:

- Officers in the precinct will continue to vigorously enforce the laws in the second precinct and investigate issues which affect the community. The Crime Prevention Specialists will disseminate requests for community impact statements on individuals who have been arrested and charged with crimes, so community members can make statements to the courts on how these individuals have affected their lives in the community, and the judge can use this information to determine the sentence of an individual.
- Reduce Burglaries by continuing to provide Home Security Audits on request from neighborhood residents for ideas to make their residences less inviting to potential burglars.
- Reduce the crimes of assault, robbery, and rape by continuing to host Personal Safety Workshops, to provide residents the opportunity to be safe when out in the neighborhood, and to promote the utilization of the Email Alert system so residents are aware of crime trends in their neighborhood.
- Continue to encourage residents to report problems in the community by calling 911, 311 and/or the Sector Crime Prevention Specialist to discuss concerns.
- Enforce the curfew and truancy laws by bringing youth who are picked for these offenses to the new Supervision Center for assessment and referral.
http://www.ci.minneapolis.mn.us/police/crime-prevention/docs/Co_curf1.pdf
- Utilize the information received from the community via 911, 311 and/or Sector Crime Prevention Specialist to assist in deploying officers in the precinct each week as discussed at the weekly CODEFOR meeting.

We will also engage in projects to increase the relationship with the community:

- We will increase communication with people in the neighborhood via the city Email Alert System which is designed to facilitate stronger communication and information sharing in the community.
<http://www.ci.minneapolis.mn.us/police/crimealert/signup.asp>
- Provide Block Club Training periodically throughout the year so residents are organized and working together and are bring concerns directly to the resources in the City, County, and private sector who can assist in resolving the issue.
- Celebrate National Night Out in the Community to strengthen block clubs and to connect community members with the officers. <http://www.ci.minneapolis.mn.us/nno/>
- Hold a State of the Precinct Program in February to update the Community on the 2nd Precinct, staffing, crime activity, and plans; also, hold an Open House in the Precinct during Police Week which is the 2nd Week in May.

2009 Neighborhood Engagement:

While the Minneapolis Police Department has committed to a number of steps to improve policing services in Waite Park Neighborhood, policing is a team effort and residents are a key part of that team. The collaboration of the Minneapolis Police Department and Waite Park Neighborhood Residents have committed to the following:

- The Waite Park Community Council offers a \$50 rebate for security upgrades and a \$100 rebate for block club events.
- Work towards adding at least one new block club in the Waite Park Neighborhood during the year. To be promoted by the Neighborhood Association and trained by the Crime Prevention Specialist. (increase from 32 to at least 33 block clubs.)
- Increasing participation of residents in the Email Alert System by 10%. (increase from 198 to 217 participants)
- Have Waite Park Neighborhood represented at the monthly (every 2nd Monday of the month 2nd Precinct Police and Community Council (2PAC) meetings.
<http://www.ci.minneapolis.mn.us/police/outreach/pac-schedule.asp>

2009 Performance Measures:

We will use the following criteria to measure success in the Waite Park Neighborhood

- 5% decrease in Part 1 Crimes in the neighborhood – continuing to concentrate on Burglary and Aggravated Robbery.
- Add at least one new block club in the neighborhood during the year.

WAITE PARK – 2008 NEIGHBORHOOD PLAN RESULTS

2008 Policing Strategy:

The Minneapolis Police Department has two citywide goals: reduce crime and improve the relationship with the community it serves. In the Waite Park neighborhood, we will be focus on the following crime reduction strategies:

- Reducing Robberies. Hosting Personal Safety Workshops to provide residents the opportunity to be safe when out in the neighborhood **Robberies decreased from 9 robberies in 2007 to 4 in 2008 in the Waite Park Neighborhood.**
- Encouraging residents to report problems in the community by calling 911, 311 and/or their Crime Prevention Specialist to discuss their concerns. **Ongoing**
- Reducing Burglaries. Offering Premise Security Surveys (contact your Sector Crime Prevention Specialist) to residents in order to make their property less inviting to criminals and promoting the utilization of the various City electronic technologies for information dissemination. **Burglaries decreased from 52 in 2007 to 41 in 2008 in Waite Park Neighborhood.**
- Utilizing the information received from the community by their reporting of problems via 911, 311 and/or the Sector Crime Prevention Specialist to assist in deploying the officers out in the precinct each week as discussed at the weekly CODEFOR meeting. **Ongoing**
- Utilize the new Juvenile Supervision Center by taking youth picked up for Curfew and Truancy status offenses to the Center for assessment and referral.

We will also engage in two projects to increase the relationship with the community:

- We will increase communication with people in the neighborhood via the city WorkSite program, which is designed to facilitate stronger communication and information sharing in the community through web-based technology.
- Provide Block Leader Training (contact your Crime Prevention Specialist) periodically throughout the year so residents are looking out for each other and that concerns are being directed to the proper City agency to handle.

Neighborhood Engagement:

While the Minneapolis Police Department has committed to a number of steps to improve policing service in Waite Park, policing is a team sport and residents are a key part of that team. The collaboration of MPD with the residents of the neighborhood have committed to the following:

- New Neighborhood Block Club. Work towards adding at least one new block club in the Waite Park Neighborhood during the year. To be promoted by the Neighborhood Association and trained by the Crime Prevention Specialist. **At the end of 2008, there were 32 block clubs in Waite Park Neighborhood.**
- Participating fully in the city WorkSite communications tool. **At the end of 2008, there were 198 subscribers for the neighborhood.**
- Assist the Minneapolis Police Department in promoting Block Leader Training and Personal Safety Workshops throughout the Waite Park Neighborhood. **Ongoing**
- Have Waite Park Neighborhood represented at the monthly 2nd Precinct Advisory Council (2 PAC) meeting held on the 2nd Monday of each month at 6:00 PM at 1900 Central Ave NE. **Ongoing**

For more information on the Waite Park Neighborhood contact waiteparkcc@gmail.com

2008 Performance Measures:

We will use the following criteria to measure success in the Waite Park Neighborhood:

- 5% decrease the number of Part 1 Crimes in the neighborhood – especially Robberies, Burglaries and Thefts. **Waite Park Neighborhood realized a 29% decrease in part one crimes in 2008. Burglaries had a 21% decrease and there was a 33% decrease in thefts.**

Add at least one new block club in the neighborhood during the year. **At the end of 2008, there were 32 block clubs in Waite Park Neighborhood.**

--- end of 2009 Plan; 2008 Results for Waite Park Neighborhood